

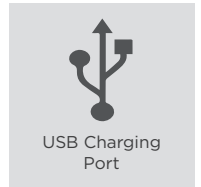

### ELEGANT AND RELIABLE PFC UPS

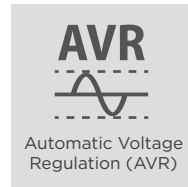
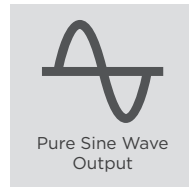
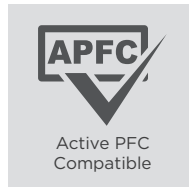
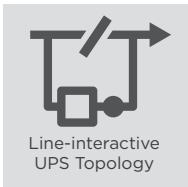

### The Pure Sine Wave UPS for equipment requiring active PFC power source

Designed for home, office and back office applications, the PFC Sinewave Series adopts line-interactive topology with Automatic Voltage Regulation (AVR) function to offer stabilized Pure Sine Wave output. The products are compatible with equipment requiring active PFC power supply. Other features include RJ11/RJ45 port to provide data line protection against surge and spike, and power management software to perform PC graceful shutdown.

#### APPLICATION

- Home
- Office
- SOHO Office
- Back Office

#### SERIES FEATURES

- Line-interactive UPS Topology
- Active PFC Compatible
- Automatic Voltage Regulation (AVR)
- Phone/Fax/Modem/DSL/Network Protection
- PowerPanel® Management Software
- Energy Saving Technology
- Pure Sine Wave Output
- Surge and Spike Protection
- LCD Status Display
- USB Charging Port

#### PRODUCT CALLOUTS

- 1 . Power On Indicator
- 2 . Power On/Off Switch
- 3 . LCD Display Panel
- 4 . Function Button(s)
- 5 . Battery Backup & Surge Protected Outlets
- 6 . Communication Protection Ports RJ11/RJ45
- 7 . USB Charging Ports
- 8 . Input Circuit Breaker
- 9 . AC Inlet
- 10 . USB Port
- 11 . Serial Port

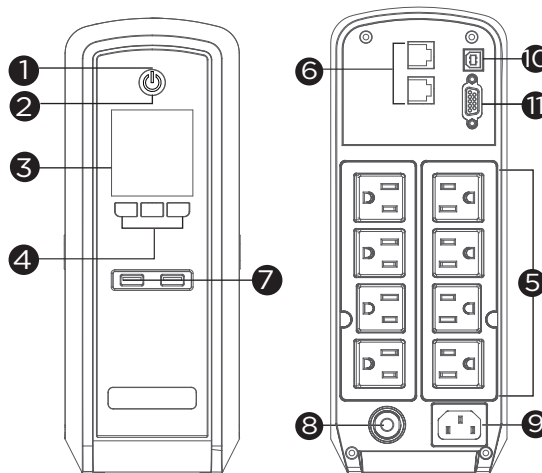

CP1300/1500EPFCLCD



**TECHNICAL SPECIFICATIONS**

Model Name	CP1300EPFCLCD	CP1500EPFCLCD
<b>General</b>		
UPS Topology	Line-interactive	Line-interactive
Energy Saving Technology	GreenPower UPS™ Bypass Technology	GreenPower UPS™ Bypass Technology
Active PFC Compatibility	Yes	Yes
<b>Input</b>		
Nominal Input Voltage (Vac)	230	230
Input Voltage Range (Vac)	170 - 270	170 - 270
Input Frequency (Hz)	50 ± 3, 60 ± 3	50 ± 3, 60 ± 3
Input Frequency Detection	Auto-sensing	Auto-sensing
Rated Input Current (A)	10	10
Input Connector Type	IEC C14	IEC C14
<b>Output</b>		
Capacity (VA)	1300	1500
Capacity (Watts)	780	900
On Battery Waveform	Pure Sine Wave	Pure Sine Wave
On Battery Voltage(s) (Vac)	230 ± 10%	230 ± 10%
On Battery Frequency (Hz)	50 ± 1%, 60 ± 1%	50 ± 1%, 60 ± 1%
Automatic Voltage Regulation (AVR)	Single Boost	Single Boost
Overload Protection	Internal Current Limiting, Circuit Breaker	Internal Current Limiting, Circuit Breaker
Outlet(s) - Total	8	8
Outlet Type	NEMA 5-15R x 8	NEMA 5-15R x 8
Outlet(s) - Battery & Surge Protected	8	8
USB Charging Port(s)	2	2
USB Charging Current (A)	2.1	2.1
Typical Transfer Time (ms)	4	4
<b>Battery</b>		
Runtime at Half Load (min)	9	10
Runtime at Full Load (min)	2.5	3
Typical Recharge Time (Hours)	8	8
User Replaceable	Yes	Yes
Battery Type	Sealed Lead-acid	Sealed Lead-acid
Replacement Battery Pack	RBP0124	RBP0016
RBP Quantity (pcs)	1	1
<b>Surge Protection &amp; Filtering</b>		
Surge Suppression (Joules)	405	405
EMI/RFI Filtration	Yes	Yes
Phone/Network Protection RJ11/RJ45 (Combo)	1-in, 1-out	1-in, 1-out
<b>Management &amp; Communications</b>		
LCD Panel	Yes	Yes
LED Indicators	Power On	Power On
HID Compliant USB Port(s)	1	1
Serial Port	Dry Contact	Dry Contact
Audible Alarms	Battery Mode, Low Battery, Overload, UPS Fault	Battery Mode, Low Battery, Overload, UPS Fault
Power Management Software	PowerPanel® Personal Edition	PowerPanel® Personal Edition
<b>Physical</b>		
Form Factor	Tower	Tower
<b>Physical Size - UPS Module</b>		
Dimensions (WxHxD) (mm.)	100 x 265 x 370	100 x 265 x 370
Weight (kg.)	10.4	11.3
<b>Environmental</b>		
Operating Temperature (°C)	0 - 40	0 - 40
Operating Relative Humidity (Non-condensing) (%)	0 - 95	0 - 95
Online Thermal Dissipation (BTU/hr)	41	61
<b>Certifications</b>		
Certifications*	CE, EAC, RCM	CE, EAC, RCM
RoHS	Yes	Yes

\*Certifications may vary according to different regions. Visit [www.cyberpower.com](http://www.cyberpower.com) for more information.  
 #All specifications are subject to change without notice.

